

Features.

- ◆ Operates at communications bands.
- ◆ Low insertion loss.
- ◆ High power.
- ◆ High isolation.
- ◆ Robust and reliable.
- ◆ IP 66-IEC 60529
- ◆ Operating temperature -45/+85°C.



Descripción.

The new line of high power hybrids has been designed for intensive use in test equipment and telecommunication installations.

Manufactured with multi section technology, to guarantee a reliable and robust behavior in the most extreme working conditions.

Custom design on frequency, power, package and electrical specifications are welcome.

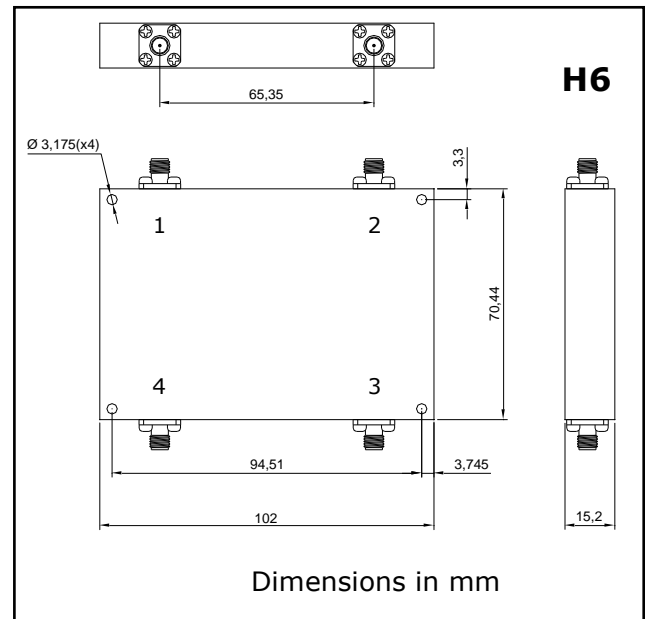
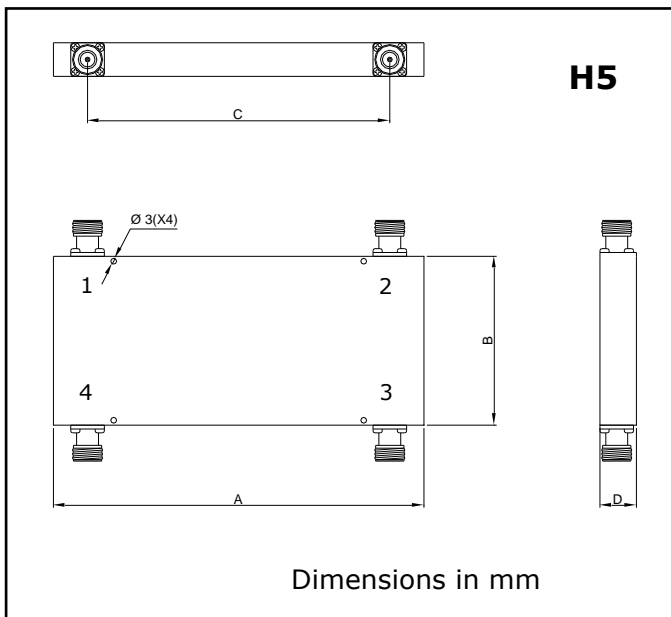

Phase diagram

IN \ OUT	1	2	3	4
1	X	ISO	0°	0°
2	ISO	X	180°	0°
3	-90°	0°	X	ISO
4	0°	-90°	ISO	X

Specifications

Model	Frequency range (MHz)	Insertion loss (dB máx)	Isolation (dB mín)	VSWR (máx)	Amplitude balance (db máx)	Phase balance (° max)	Power (W max)	Package
IF-H180-21/N	670-1100	0.4	20	1.35/1	1	3	200	H5
IF-H180-41/N	1100-1700	0.65	20	1.45/1	1	3	200	H5
IF-H180-11/S	1700-2600	0.65	20	1.45/1	1	3	200	H6